

# K-7

## OFFSET PIPE CLAMP

SIZE RANGE - 1/2" THRU 12" PIPE SIZE

MATERIAL - CARBON STEEL AND STAINLESS STEEL

FUNCTION - OFFSET PIPE CLAMPS ARE USED TO SUPPORT PIPE LINES RUNNING AT A DEFINITE DISTANCE FROM THE WALL OR FLOOR OF BUILDING. THE STANDARD CLEARANCE IS TWO INCHES FROM BACK OF PIPE TO WALL OR FLOOR LINE. WHEN OTHER CLEARANCES ARE DESIRED CLAMPS WILL BE FURNISHED TO ORDER.

MAXIMUM TEMPERATURE - 650°

FINISH - PLAIN, ELECTRO-GALVANIZED AND HDG

ORDER BY - FIGURE NUMBER, PIPE SIZE AND FINISH

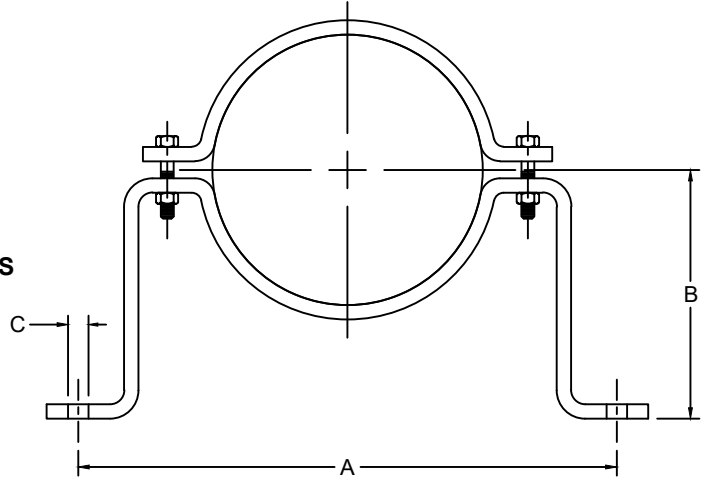

PIPE SIZE	A	B	C	BOLT SIZE	MAX REC. LOAD LBS.	APPROX. WEIGHT PER 100
1/2	5-13/16	2-7/16	7/16	3/8 x 1 1/4	190	107
3/4	5-15/16	2-1/2	7/16	3/8 x 1 1/4	190	109
1	6-1/4	2-5/8	7/16	3/8 x 1 1/4	190	116
1-1/4	6-11/16	2-3/4	7/16	3/8 x 1 1/4	190	126
1-1/2	6-15/16	3	7/16	3/8 x 1 1/4	190	134
2	8-5/16	3-3/16	7/16	3/8 x 1 1/4	420	191
2-1/2	8-7/8	3-7/16	7/16	3/8 x 1 1/4	420	209
3	9-1/2	3-3/4	7/16	3/8 x 1 1/4	420	232
3-1/2	10-1/16	4	7/16	3/8 x 1 1/4	420	250
4	10-9/16	4-1/4	9/16	1/2 x 1 1/2	610	327
5	11-11/16	4-3/4	9/16	1/2 x 1 1/2	610	370
6	14-3/8	5-5/16	9/16	1/2 x 2	870	650
8	16-7/16	6-5/16	9/16	1/2 x 2	870	787
10	21-1/2	7-3/8	13/16	3/4 x 2	925	1238
12	24-7/8	8-3/8	13/16	3/4 x 2	1225	2100