



MINI NUT WITH STANDARD SPRING

CATALOG NUMBER	SIZE		THREAD	THICKNESS		WEIGHT PER 100	
	in	mm		in	mm	lbs	kg
N-6-0836	#8	N/A	36	0.150	3.8	1.0	0.5
N-6-0832	#8	N/A	32	0.150	3.8	1.0	0.5
N-6-1032	#10	N/A	32	0.150	3.8	1.0	0.5
N-6-1024	#10	N/A	24	0.150	3.8	1.0	0.5
N-6-4	1/4	6.3	20	0.150	3.8	1.0	0.5



For N-600 Channel

MINI NUT WITH SHORT SPRING

CATALOG NUMBER	SIZE		THREAD	THICKNESS		WEIGHT PER 100	
	in	mm		in	mm	lbs	kg
N-7-0836	#8	N/A	36	0.150	3.8	1.0	0.5
N-7-0832	#8	N/A	32	0.150	3.8	1.0	0.5
N-7-1032	#10	N/A	32	0.150	3.8	1.0	0.5
N-7-1024	#10	N/A	24	0.150	3.8	1.0	0.5
N-7-4	1/4	6.3	20	0.150	3.8	1.0	0.5



For N-700 Channel

NO-TWIST SQUARE WASHER

CATALOG NUMBER	BOLT SIZE		HOLE SIZE		WEIGHT PER 100	
	in	mm	in	mm	lbs	kg
N-1002	5/16	7.9	11/32	8.7	18	8.2
N-1003	3/8	9.5	7/16	11.1	18	8.2
N-1004	1/2	12.7	9/16	14.3	17	7.7
N-1005	5/8	15.9	11/16	17.5	16	7.3
N-1006	3/4	19.0	13/16	20.6	15	6.8

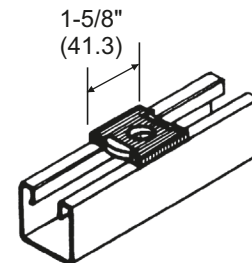

FLAT SQUARE WASHER (WITHOUT INDENT)

CATALOG NUMBER	BOLT SIZE		HOLE SIZE		WEIGHT PER 100	
	in	mm	in	mm	lbs	kg
N-1002 F	5/16	7.9	11/32	8.7	18	8.2
N-1003 F	3/8	9.5	7/16	11.1	18	8.2
N-1004 F	1/2	12.7	9/16	14.3	17	7.7
N-1005 F	5/8	15.9	11/16	17.5	16	7.3
N-1006 F	3/4	19.0	13/16	20.6	15	6.8

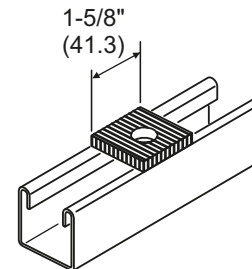



TWO-HOLE SPLICE PLATE

CATALOG NUMBER	WEIGHT PER 100
N-1007	38 Lbs (17.3 Kg)

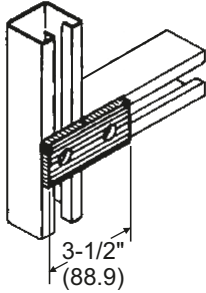

TWO-HOLE SPLICE PLATE

CATALOG NUMBER	WEIGHT PER 100
N-1011	35 Lbs (15.9 Kg)

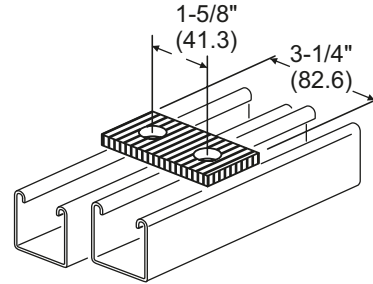

THREE-HOLE SPLICE PLATE

CATALOG NUMBER	WEIGHT PER 100
N-1008	59 Lbs (26.8 Kg)

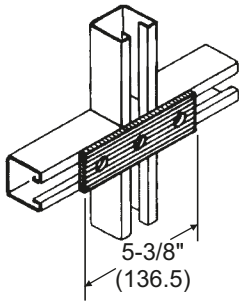

THREE-HOLE SWIVEL PLATE

CATALOG NUMBER	WEIGHT PER 100
N-1012	74 Lbs (33.6 Kg)

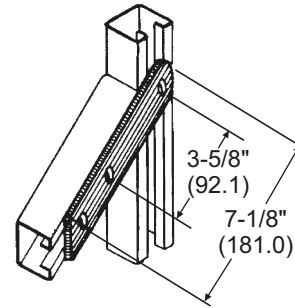

FOUR-HOLE SPLICE PLATE

CATALOG NUMBER	WEIGHT PER 100
N-1009	76 Lbs (34.5 Kg)

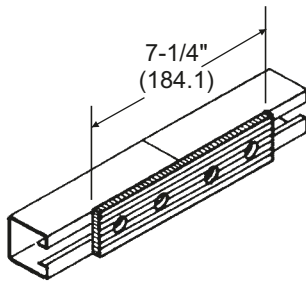

TWO-HOLE SWIVEL PLATE

CATALOG NUMBER	WEIGHT PER 100
N-1013	55 Lbs (25.0 Kg)

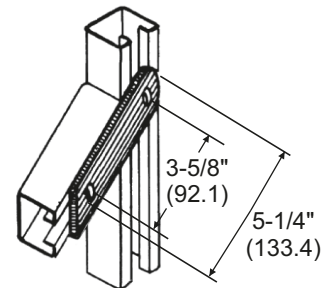

FIVE-HOLE SPLICE PLATE

CATALOG NUMBER	WEIGHT PER 100
N-1010	94 Lbs (42.75 Kg)

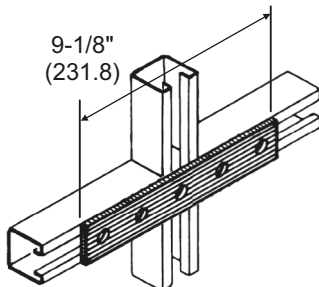

FOUR-HOLE SPLICE PLATE

CATALOG NUMBER	WEIGHT PER 100
N-1014	73 Lbs (33.1 Kg)

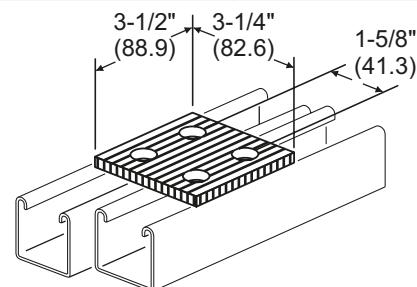

FITTING DATA: Each fitting 1/4" thick, 1 5/8" wide • Holes 9/16" diameter, centered 1 7/8" apart, 13/16" from edge



KUMAR INDUSTRIES, INC. TEL: (909) 591-0722 FAX: (909) 591-6334

THREE-HOLE FLAT CORNER PLATE	
CATALOG NUMBER	WEIGHT PER 100
N-1021	58 Lbs (26.3 Kg)

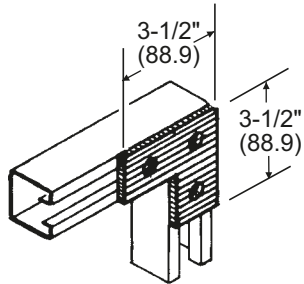

FOUR-HOLE FLAT CORNER PLATE	
CATALOG NUMBER	WEIGHT PER 100
N-1025	80 Lbs (36.3 Kg)

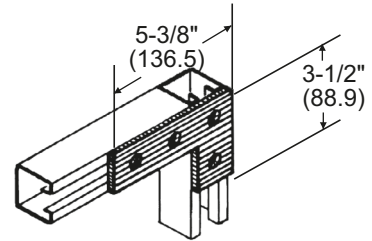

TEE PLATE	
CATALOG NUMBER	WEIGHT PER 100
N-1022	80 Lbs (36.3 Kg)

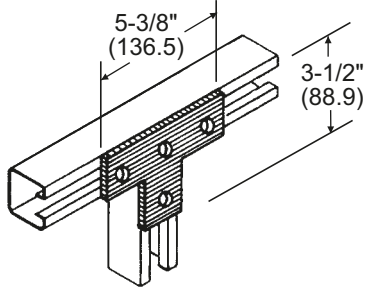

FOUR-HOLE PLATE	
CATALOG NUMBER	WEIGHT PER 100
N-1026	100 Lbs (45.4 Kg)

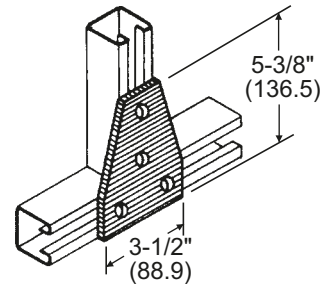

CROSS PLATE	
CATALOG NUMBER	WEIGHT PER 100
N-1023	100 Lbs (45.4 Kg)

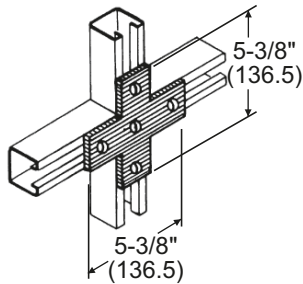

FIVE-HOLE PLATE	
CATALOG NUMBER	WEIGHT PER 100
N-1027	145 Lbs (65.8 Kg)

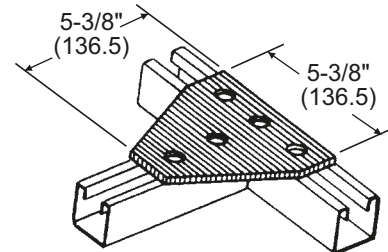

FOUR-HOLE CORNER PLATE	
CATALOG NUMBER	WEIGHT PER 100
N-1024	105 Lbs (47.7 Kg)

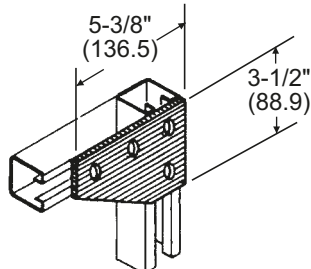

SIX-HOLE PLATE	
CATALOG NUMBER	WEIGHT PER 100
N-1028	176 Lbs (79.9 Kg)

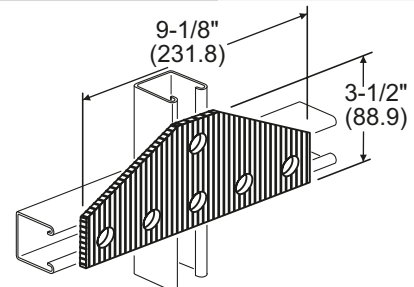

FITTING DATA: Each fitting 1/4" thick, 1 5/8" wide • Holes 9/16" diameter, centered 1 7/8" apart, 13/16" from edge

PRODUCTS WITH INTEGRITY