

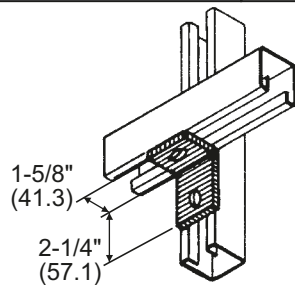

TWO-HOLE RACK CONNECTOR ANGLE

CATALOG NUMBER	WEIGHT PER 100
N-1102	36 Lbs (16.3 Kg)



TWO-HOLE ADJUSTMENT ANGLE 1-5/8"

CATALOG NUMBER	WEIGHT PER 100
N-1106	36 Lbs (16.3 Kg)

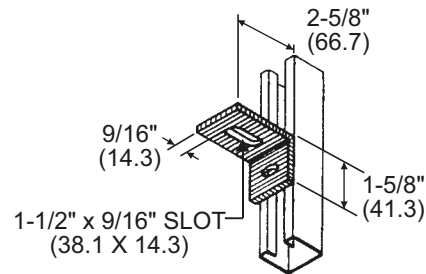

TWO-HOLE END CONNECTOR ANGLE

CATALOG NUMBER	WEIGHT PER 100
N-1103	36 Lbs (16.3 Kg)

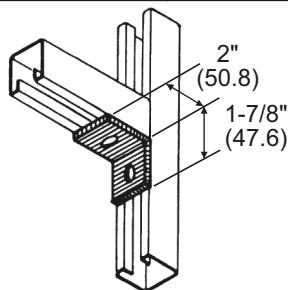

TWO-HOLE ADJUSTMENT ANGLE

CATALOG NUMBER	WEIGHT PER 100
N-1107	65 Lbs (29.5 Kg)

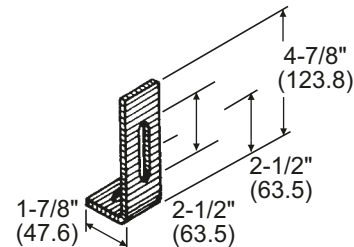

TWO-HOLE "NO-TWIST" CORNER ANGLE

CATALOG NUMBER	WEIGHT PER 100
N-1104	40 Lbs (18.2 Kg)

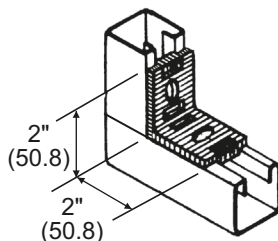

TWO-HOLE ADJUSTMENT ANGLE

CATALOG NUMBER	WEIGHT PER 100
N-1108	85 Lbs (38.6 Kg)

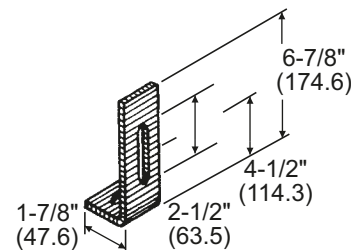

TWO-HOLE ADJUSTMENT ANGLE 2"

CATALOG NUMBER	WEIGHT PER 100
N-1105	40 Lbs (18.2 Kg)

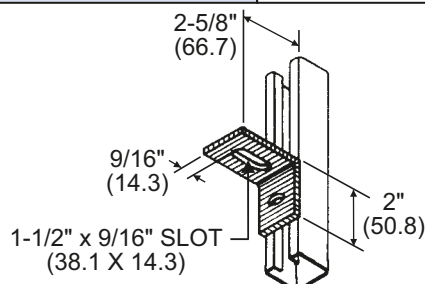

FOUR-HOLE SHELF ANGLE

CATALOG NUMBER	WEIGHT PER 100
N-1109	102 Lbs (46.3 Kg)

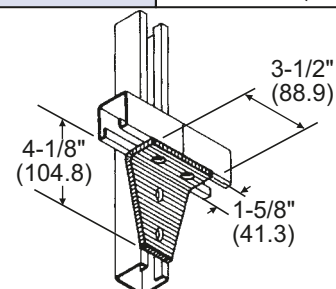

FITTING DATA: Each fitting 1/4" thick, 1 5/8" wide • Holes 9/16" diameter, centered 1 7/8" apart, 13/16" from edge



THREE-HOLE SHELF ANGLE	
CATALOG NUMBER	WEIGHT PER 100
N-1110	67 Lbs (30.4 Kg)

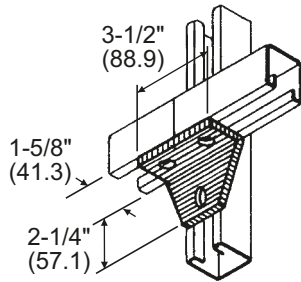

FIVE-HOLE THREE-WAY SHELF ANGLE	
CATALOG NUMBER	WEIGHT PER 100
N-1117	135 Lbs (61.3 Kg)

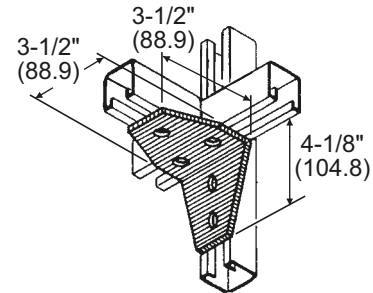

THREE-HOLE RACK CONNECTOR ANGLE	
CATALOG NUMBER	WEIGHT PER 100
N-1112	58 Lbs (26.3 Kg)

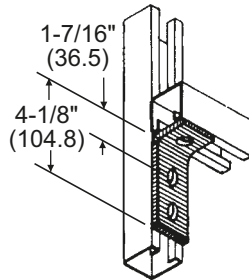

FOUR-HOLE RACK CORNER ANGLE	
CATALOG NUMBER	WEIGHT PER 100
N-1123	74 Lbs (33.6 Kg)

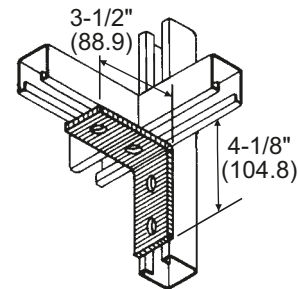

THREE-HOLE END CONNECTOR ANGLE	
CATALOG NUMBER	WEIGHT PER 100
N-1113	58 Lbs (26.3 Kg)

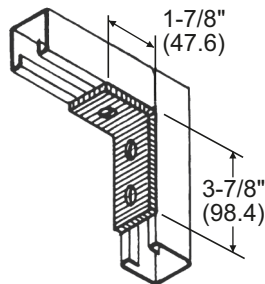

UNIVERSAL SHELF BRACKET	
CATALOG NUMBER	WEIGHT PER 100
N-1124	132 Lbs (59.9 Kg)

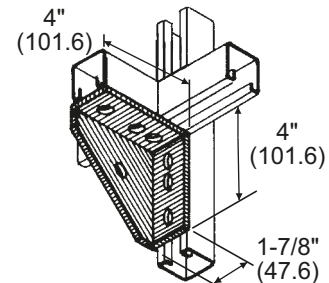

THREE-HOLE RACK CORNER ANGLE	
CATALOG NUMBER	WEIGHT PER 100
N-1115	54 Lbs (24.5 Kg)

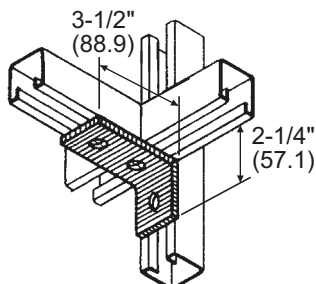

FOUR-HOLE CORNER ANGLE	
CATALOG NUMBER	WEIGHT PER 100
N-1125	76 Lbs (34.5 Kg)

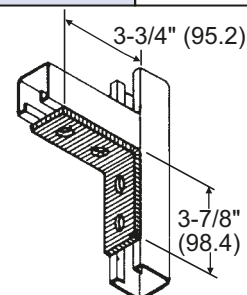

FITTING DATA: Each fitting 1/4" thick, 1 5/8" wide • Holes 9/16" diameter, centered 1 7/8" apart, 13/16" from edge



TWO-HOLE SLOTTED ANGLE

CATALOG NUMBER	WEIGHT PER 100
N-1126	66 Lbs (29.9 Kg)

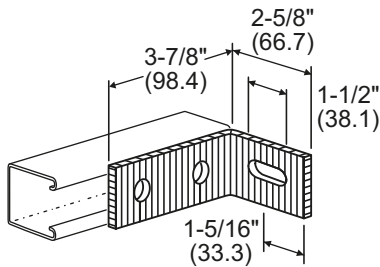

THREE-HOLE BENT ANGLE RIGHT HAND

CATALOG NUMBER	WEIGHT PER 100
N-1135	65 Lbs (29.5 Kg)

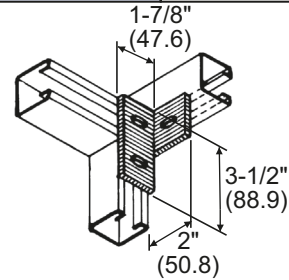

TWO-HOLE ANGLE

CATALOG NUMBER	A		WEIGHT PER 100	
	in	mm	lbs	kg
N-1127	3	76.2	49	22.2
N-1128	3-1/2	88.9	54	24.5
N-1129	4	101.6	61	27.7

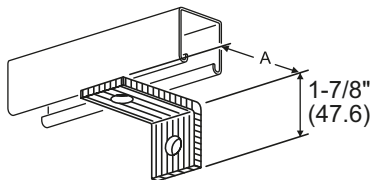

THREE-HOLE BENT ANGLE LEFT HAND

CATALOG NUMBER	WEIGHT PER 100
N-1136	65 Lbs (29.5 Kg)

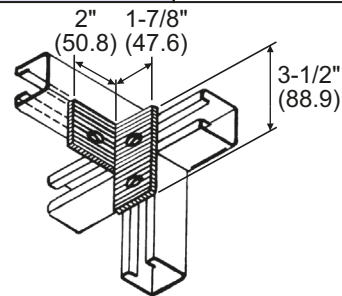

TWO-HOLE TWO-SLOTTED ANGLE

CATALOG NUMBER	A		B		WT. PER 100	
	in	mm	in	mm	lbs	kg
N-1130	6-5/8	168.3	4	101.6	190	86.2
N-1131	8-5/8	219.1	6	152.4	242	109.8

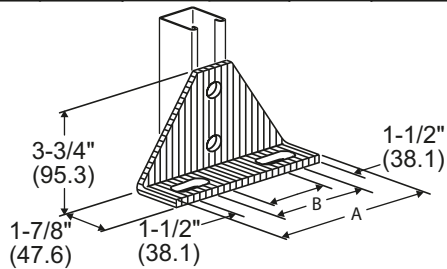

FOUR-HOLE BENT ANGLE

CATALOG NUMBER	WEIGHT PER 100
N-1137	80 Lbs (36.3 Kg)

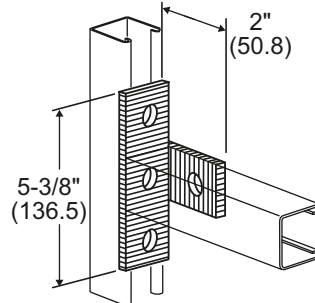

FOUR-HOLE TWO-WIDE CONNECTOR ANGLE

CATALOG NUMBER	WEIGHT PER 100
N-1132	75 Lbs (34.1 Kg)

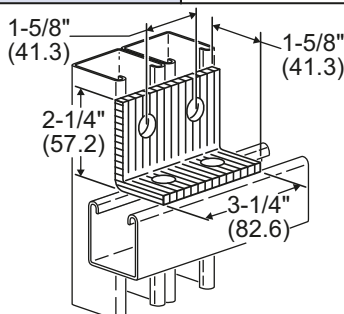

BENT ANGLE WITH STUD

CATALOG NUMBER	WEIGHT PER 100
N-1141	45 Lbs (20.4 Kg)

N-3463 Nut Required

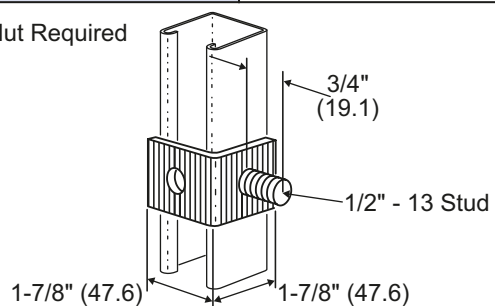

FITTING DATA: Each fitting 1/4" thick, 1 5/8" wide • Holes 9/16" diameter, centered 1 7/8" apart, 13/16" from edge